

# ПЦ1-1700

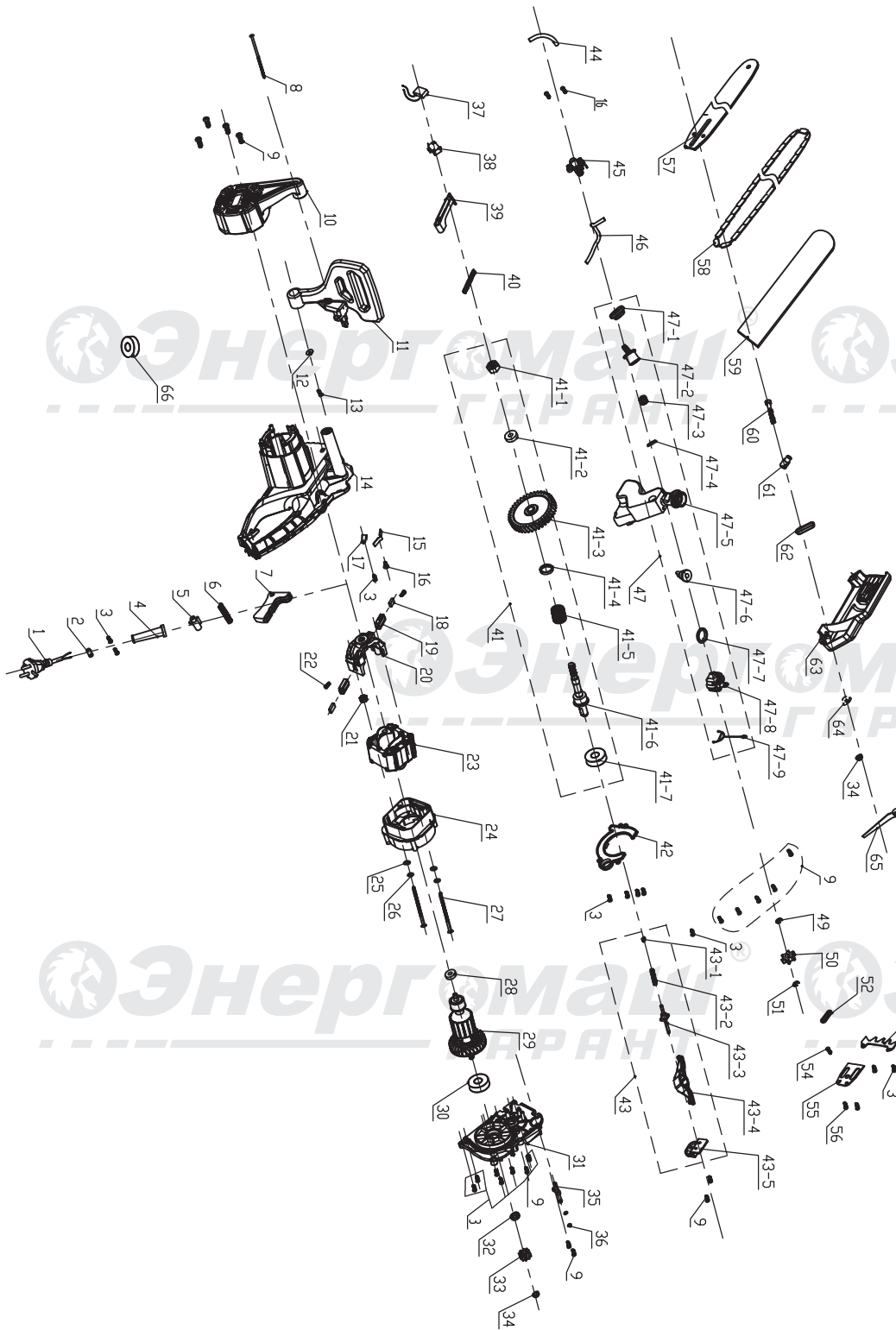

| NO.  | DESCRIPTION           | SPEC    | NO.  | DESCRIPTION              | SPEC   |
|------|-----------------------|---------|------|--------------------------|--------|
| 1    | CABLE                 |         | 41-4 | SHAFT SLEEVE             |        |
| 2    | CABLE ANCHORAGE       |         | 41-5 | BRAKE TORSION SPRING     |        |
| 3    | SCREW                 | ST4X12  | 41-6 | OUTPUT SHAFT             |        |
| 4    | CABLE PROTECTOR       |         | 41-7 | BEARING                  | 6000RS |
| 5    | SAFETY LOCKING BUTTON |         | 42   | GEAR CASE COVER          |        |
| 6    | SPRING                |         | 43   | BRAKE LEVER ASSEMBLY     |        |
| 7    | SWITCH TRIGGER        |         | 43-1 | WASHER                   | Φ5     |
| 8    | SCREW                 | ST5X150 | 43-2 | SPRING                   |        |
| 9    | SCREW                 | ST4X16  | 43-3 | BRAKE LEVER              |        |
| 10   | REAR COWL             |         | 43-4 | CONNECTING ROD           |        |
| 11   | PROTECTIVE PLATE      |         | 43-5 | BRAKE FIXING PLATE       |        |
| 12   | WASHER                | Φ5      | 44   | TUBING                   |        |
| 13   | SCREW                 | ST5X16  | 45   | OIL PUMP COMPONENTS      |        |
| 14   | LEFT HOUSING          |         | 46   | TUBING                   |        |
| 15   | LEAF SPRING           |         | 47   | OIL TANK ASSEMBLY        |        |
| 16   | SCREW                 | ST3X8   | 47-1 | SEALING RING             |        |
| 17   | WASHER                |         | 47-2 | FUEL TANK JOINT          |        |
| 18   | CARBON BRUSH          |         | 47-3 | SPONGE                   |        |
| 19   | BRUSH HOLDER          |         | 47-4 | PLUG                     |        |
| 20   | MOTOR BACK BRACKET    |         | 47-5 | OIL TANK                 |        |
| 21   | NUT M4                | M4      | 47-6 | CHECK VALVE              |        |
| 22   | SCREW                 | ST3X8   | 47-7 | O-RING                   |        |
| 23   | STATOR                |         | 47-8 | OIL TANK COVER           |        |
| 24   | MOTOR FRONT BRACKET   |         | 47-9 | POTHOOK                  |        |
| 25   | WASHER                | Φ4      | 48   | RIGHT HOUSING            |        |
| 26   | SPRING WASHER         | Φ4      | 49   | SPRING                   |        |
| 27   | SCREW                 | M4X56   | 50   | WHEEL                    |        |
| 28   | BEARING               | 608RS   | 51   | CIRCLIP                  | Φ7     |
| 29   | ROTOR                 |         | 52   | RUBBER RING              |        |
| 30   | BEARING               | 6000RS  | 53   | BUMPER SPIKE             |        |
| 31   | GEAR BOX              |         | 54   | SCREW                    | M5X20  |
| 32   | SHAFT SLEEVE          |         | 55   | CHAIN PLATE FIXING PLATE |        |
| 33   | PINION GEAR           |         | 56   | SCREWST4X10              | ST4X10 |
| 34   | NUT                   | M8      | 57   | CHAIN BAR                |        |
| 35   | OUT OF THE NOZZLE     |         | 58   | CHAIN                    |        |
| 36   | O-RING                |         | 59   | SCABBARD                 |        |
| 37   | CAPATICY              |         | 60   | TENSIONING SCREW         | M5X45  |
| 38   | SWITCH                |         | 61   | TENSIONING BLOCK         |        |
| 39   | PUSH ROD              |         | 62   | RUBBER RING              |        |
| 40   | SPRING                |         | 63   | CHAIN COVER              |        |
| 41   | BIG GEAR ASSEMBLY     |         | 64   | LOCATING SLEEVE          |        |
| 41-1 | NUT                   | M8      | 65   | WRENCH                   |        |
| 41-2 | BEARING               | 608RS   | 66   | INDUCTOR                 |        |
| 41-3 | BIG GEAR              |         |      |                          |        |